



# FOR LEASE PRIME RETAIL CORNER



**925 WILSHIRE BOULEVARD  
SANTA MONICA, CA 90401**

- Join Fed-ex and CrossFit Sandbox
- High identity corner space with 39 feet of Wilshire Boulevard frontage
- Ideal for a financial institution
- Heavy traffic counts in high income area
- Located near downtown Santa Monica
- Short walk to 3<sup>rd</sup> Street Promenade

**SIZE:** Approximately 3,250 rentable square feet (Possibly divisible to units of approximately 1,625 square feet. Call broker for demising rate)

**RATE:** \$5.95 per square foot per month, NNN (NNN estimated to be \$1.00 per square foot per month)

**TERM:** 5 - 10 years

**PARKING:** 32 shared spaces behind building

**AVAILABLE:** Immediately

**ARTHUR PETER**  
310.395.2663 x101  
ARTHUR@PARCOMMERCIAL.COM  
Lic# 01068613

**MIRIAM JANOUSEK**  
310.395.2663 x127  
MIRIAM@PARCOMMERCIAL.COM  
Lic# 01303051

**RAFAEL PADILLA**  
310.395.2663 x102  
RAFAEL@PARCOMMERCIAL.COM  
Lic# 00960188

1250 6th St., #303, Santa Monica, CA 90401 • 310.395.2663 • www.parcommercial.com



# FLOOR PLAN

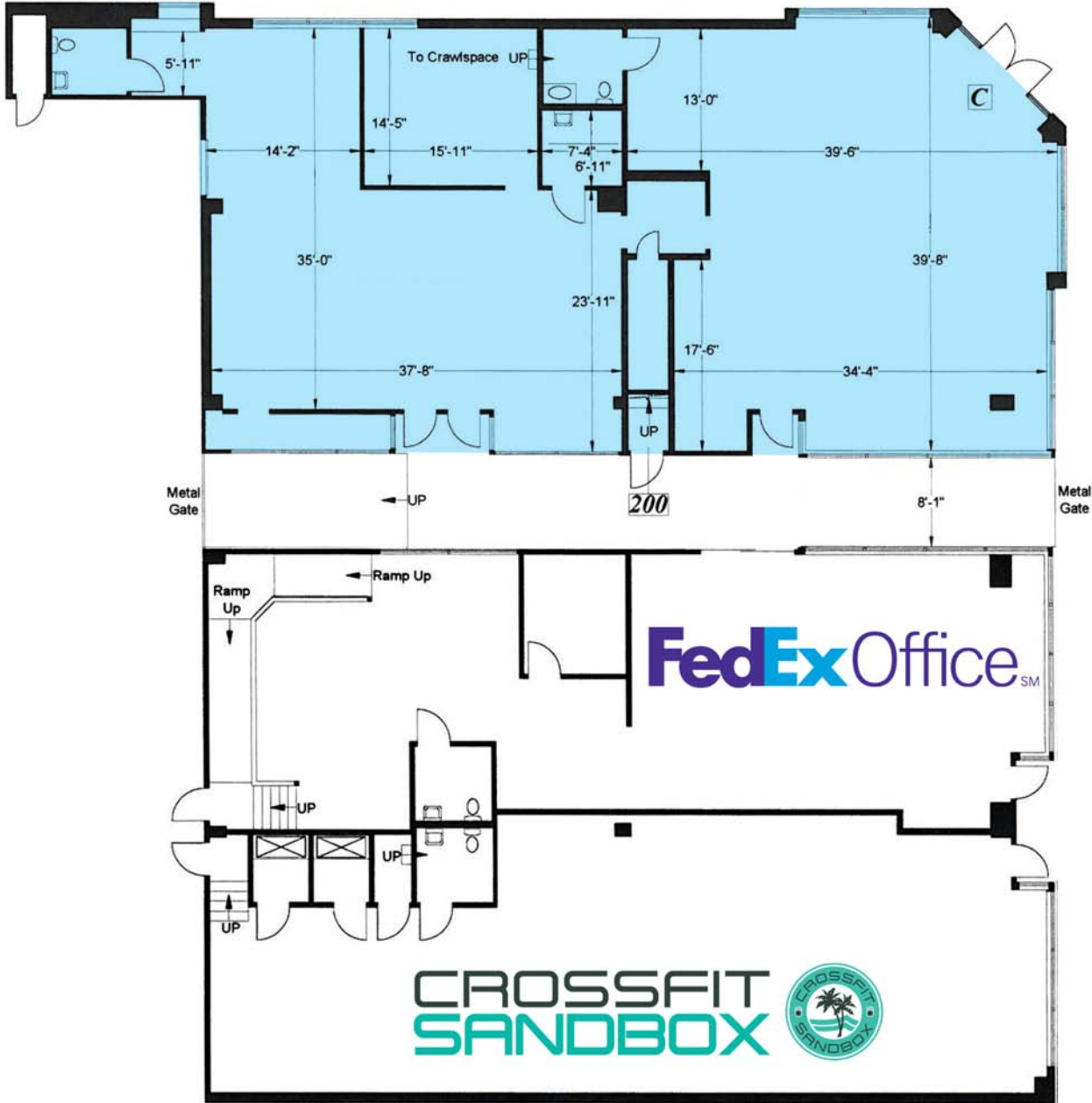

WILSHIRE BLVD

ADJACENT BLDG

**ARTHUR PETER**  
 310.395.2663 x101  
 ARTHUR@PARCOMMERCIAL.COM  
 Lic# 01068613

**MIRIAM JANOUSEK**  
 310.395.2663 x127  
 MIRIAM@PARCOMMERCIAL.COM  
 Lic# 01303051

**RAFAEL PADILLA**  
 310.395.2663 x102  
 RAFAEL@PARCOMMERCIAL.COM  
 Lic# 00960188





# NEIGHBORHOOD HIGHLIGHTS

**Logos at the top:** Ameritrade, Lake Coffee Beans & Tea Loft, FedEx Office, El Chorro, Fidelity Investments, Krispy Kreme Doughnuts, VONS, CVS pharmacy, USbank, Bank of America.

**Logos at the bottom:** Panera Bread, Whole Foods Market, MENDOCINO FARMS sandwich market, CHASE, 7-ELEVEN, BAJA FRESH MEXICAN + GRILL, charles SCHWAB, SANTA MONICA SEAFOOD, STARBUCKS, DUNKIN' DONUTS.

**Map Labels:** Lincoln Blvd, Wilshire Blvd, California Ave, Washington Ave, 14th St, 13th St, 12th St, 11th St, 10th St, 9th St, 8th St, 7th St, 6th St, 5th St, 4th St, 3rd St, 2nd St, 1st St, Euclid St, Santa Monica Blvd, Arizona Ave, 14th St, 13th St, 12th St, 11th St, 10th St, 9th St, 8th St, 7th St, 6th St, 5th St, 4th St, 3rd St, 2nd St, 1st St.

**Pin Location:** 925 Wilshire Boulevard

**ARTHUR PETER**  
310.395.2663 x101  
ARTHUR@PARCOMMERCIAL.COM  
Lic# 01068613

**MIRIAM JANOUSEK**  
310.395.2663 x127  
MIRIAM@PARCOMMERCIAL.COM  
Lic# 01303051

**RAFAEL PADILLA**  
310.395.2663 x102  
RAFAEL@PARCOMMERCIAL.COM  
Lic# 00960188