



GROUND FLOOR RETAIL SPACE FOR LEASE IN DESTINATION NEIGHBORHOOD CENTER



**8950 OLYMPIC BOULEVARD, SUITES 112 & 113
BEVERLY HILLS, CA 90212**

SUITE 112: Approximately 1,040 square feet
at \$3.95 per square foot per month, NNN
1 parking space at \$150 per month

SUITE 113: Approximately 2,500 square feet
at \$4.95 per square foot per month, NNN
1 parking space included, up to 4 space at
\$150 per space per month

112 & 113 COMBINED: Approximately 3,540 square
feet at \$4.65 per square foot
per month, NNN

NNN: Estimated to be \$1.46 per square foot per month

TERM: 3 - 10 years

AVAILABLE: April 1, 2018

- Near downtown Beverly Hills, Century City, Robertson and Beverly Drive Restaurants
- 112 was a former hair salon
- 113 has access to the loading dock; ideal space for a bank
- Busy signalized corner center
- Abundance of parking, surface and subterranean

GREG ECKHARDT
310.395.2663 X103
GECKO@PARCOMMERCIAL.COM
LIC# 01255469

1250 6th St., #303, Santa Monica, CA 90401 • 310.395.2663 • www.parcommercial.com



Floor Plan For Suites 112 & 113

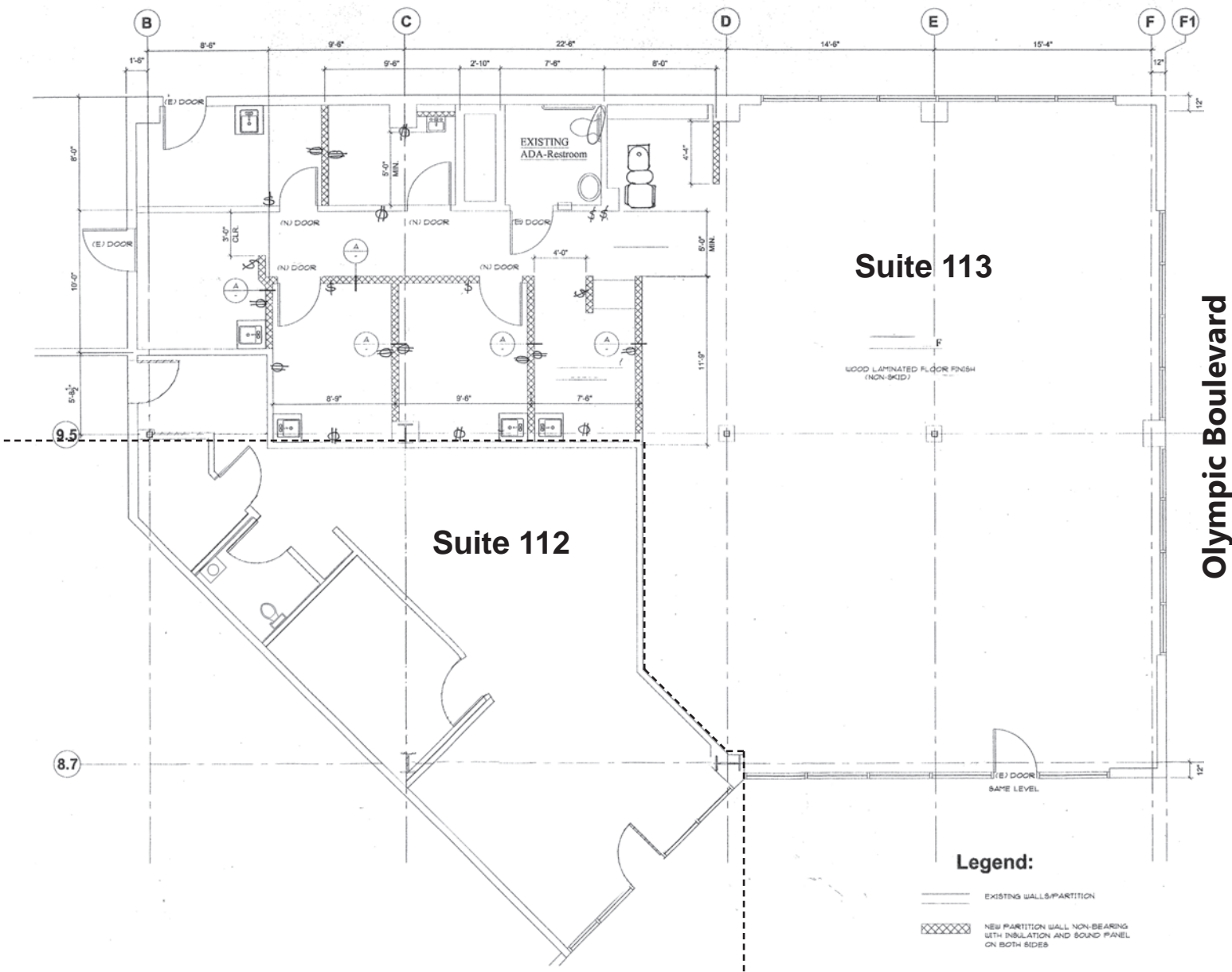

GREG ECKHARDT
310.395.2663 X103

GECKO@PARCOMMERCIAL.COM

LIC# 01255469

1250 6th St., #303, Santa Monica, CA 90401 • 310.395.2663 • www.parcommercial.com



Property Map & Photo



GREG ECKHARDT
310.395.2663 X103

GECKO@PARCOMMERCIAL.COM
LIC# 01255469

1250 6th St., #303, Santa Monica, CA 90401 • 310.395.2663 • www.parcommercial.com