

410 BROADWAY
Santa Monica, CA 90401

RETAIL SPACE NEAR WORLD
FAMOUS 3RD STREET PROMENADE
AND JUST BLOCKS FROM THE BEACH



FOR LEASE



BRIAN BOWEN
310.395.2663 x134
BRIAN@PARCOMMERCIAL.COM
LIC# 01930301

410 Broadway, Santa Monica, CA 90401

SIZE: Approximately 910 square feet

RATE: \$6,250 per month, NNN
(NNN estimated to be \$0.66 per square foot per month)

AVAILABLE: Immediately

PARKING: Available in nearby city parking structures

TERM: 3 - 5 years (negotiable)



- Open floor plan with storage and private bathroom
- High income area with foot traffic and strong demographics
- Adjacent to the world famous Third Street Promenade and Santa Monica Place
- Located in the heart of Santa Monica close to great restaurants, shopping and a new Target opening in 2020
- One block from the metro expo line's terminus at 4th Street & Colorado



FLOOR PLAN

Broadway

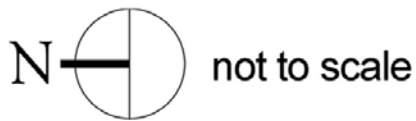
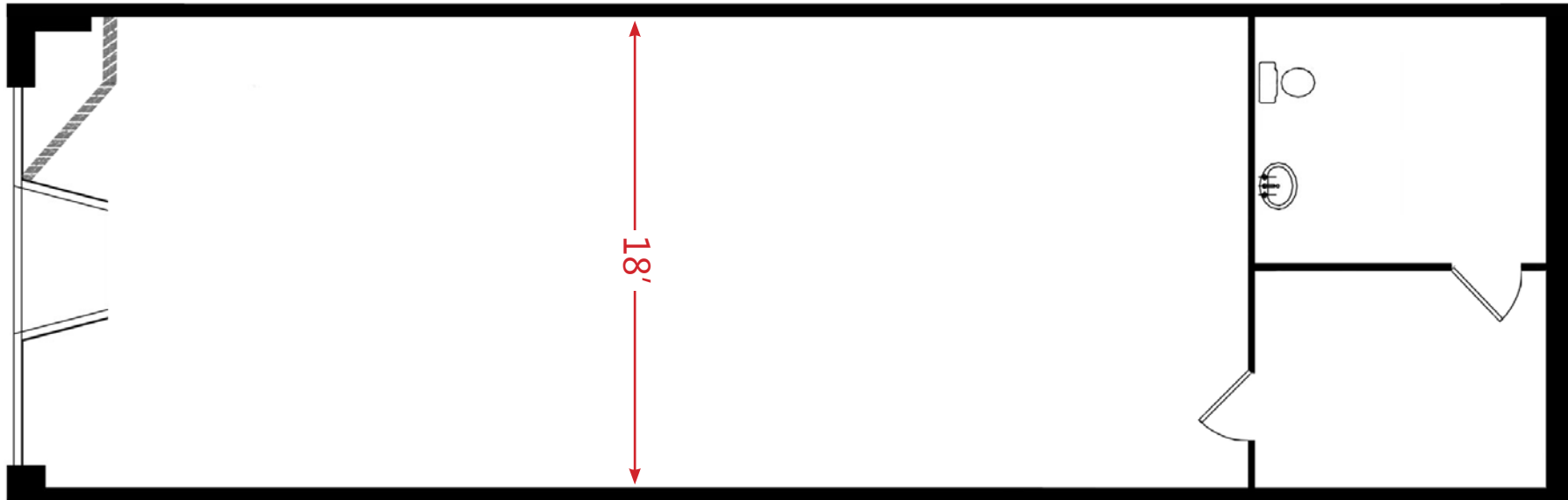

www.parcommercial.com

BRIAN BOWEN
310.395.2663 X134

BRIAN@PARCOMMERCIAL.COM
LIC# 01930301

All information furnished is from sources deemed reliable and which we believe to be correct, but no representation or guarantee is given as to its accuracy and is subject to errors and omissions. All measurements are approximate and have not been verified by Broker. You are advised to conduct an independent investigation to verify all information.

AREA MAP

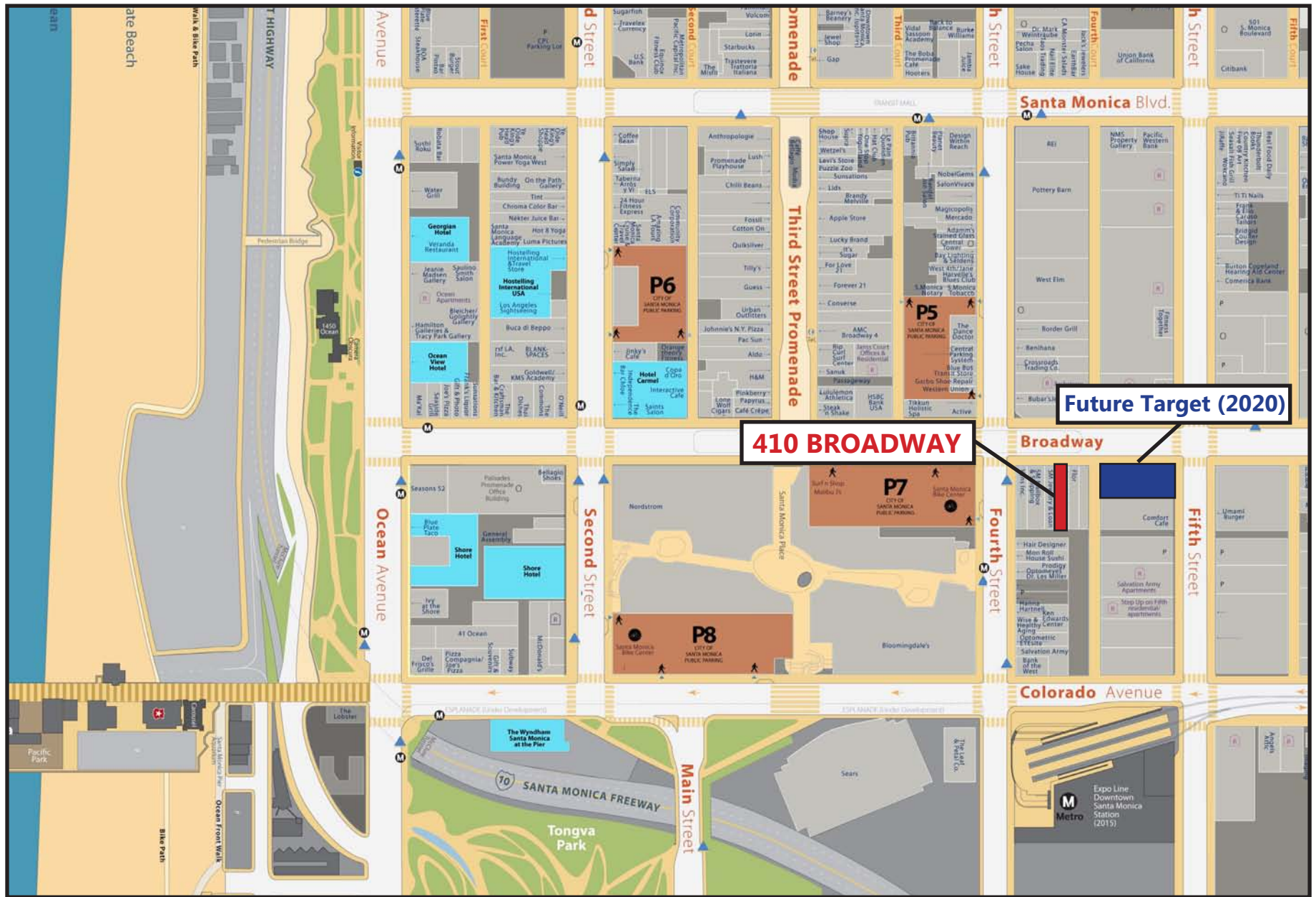

www.parcommercial.com

BRIAN BOWEN
310.395.2663 X134
BRIAN@PARCOMMERCIAL.COM
LIC# 01930301

All information furnished is from sources deemed reliable and which we believe to be correct, but no representation or guarantee is given as to its accuracy and is subject to errors and omissions. All measurements are approximate and have not been verified by Broker. You are advised to conduct an independent investigation to verify all information.

LOCAL HIGHLIGHTS

Santa Monica is a world-class shopping, dining and entertainment destination just a stone's throw from the Pacific Ocean. Over 6.5 million visitors a year come from around the globe to visit Santa Monica, named one of National Geographic's top ten beach cities in the world.



www.parcommercial.com

BRIAN BOWEN
310.395.2663 X134
BRIAN@PARCOMMERCIAL.COM
LIC# 01930301

All information furnished is from sources deemed reliable and which we believe to be correct, but no representation or guarantee is given as to its accuracy and is subject to errors and omissions. All measurements are approximate and have not been verified by Broker. You are advised to conduct an independent investigation to verify all information.