

1250 6TH STREET #100
Santa Monica, CA 90401

Ground Floor Office/Medical Space
FOR LEASE

**A HEALTHY ALTERNATIVE TO
TRADITIONAL OFFICE BUILDINGS**

- No contact office access
- Open lobby, hallways and main stairwell provide fresh air flow



- Each suite has its own HVAC airflow system separated from the HVAC airflow of other office suites



RAFAEL PADILLA

310.395.2663 X102

RAFAEL@PARCOMMERCIAL.COM

LIC# 00960188

GREG ECKHARDT

310.395.2663 X103

GECKO@PARCOMMERCIAL.COM

LIC#01255469

1250 6TH Street, #100 • Santa Monica, CA 90401

SIZE: Approximately 761 total square feet

RATE: \$5.00 per square foot per month, **Full Service Gross**

TERM: 1-4 Years

PARKING: On site parking available

AVAILABLE: Immediately

- **Open work area ideal for office space or physical therapist**
- **Includes 1 interior room**
- **Huge floor to ceiling windows allowing an abundance of natural light**
- **Private ground floor entrance**
- **Mediterranean style building combines old-world charm with modern design and technology**
- **Landscaped courtyard with artistic water feature**
- **Easy access to building parking**
- **A short walk to Third Street Promenade and Palisades Park**



www.parcommercial.com

RAFAEL PADILLA

310.395.2663 X102

RAFAEL@PARCOMMERCIAL.COM

LIC# 00960188

GREG ECKHARDT

310.395.2663 X103

GECKO@PARCOMMERCIAL.COM

LIC#01255469

Floor Plan

F
L
O
O
R

P
L
A
N
S

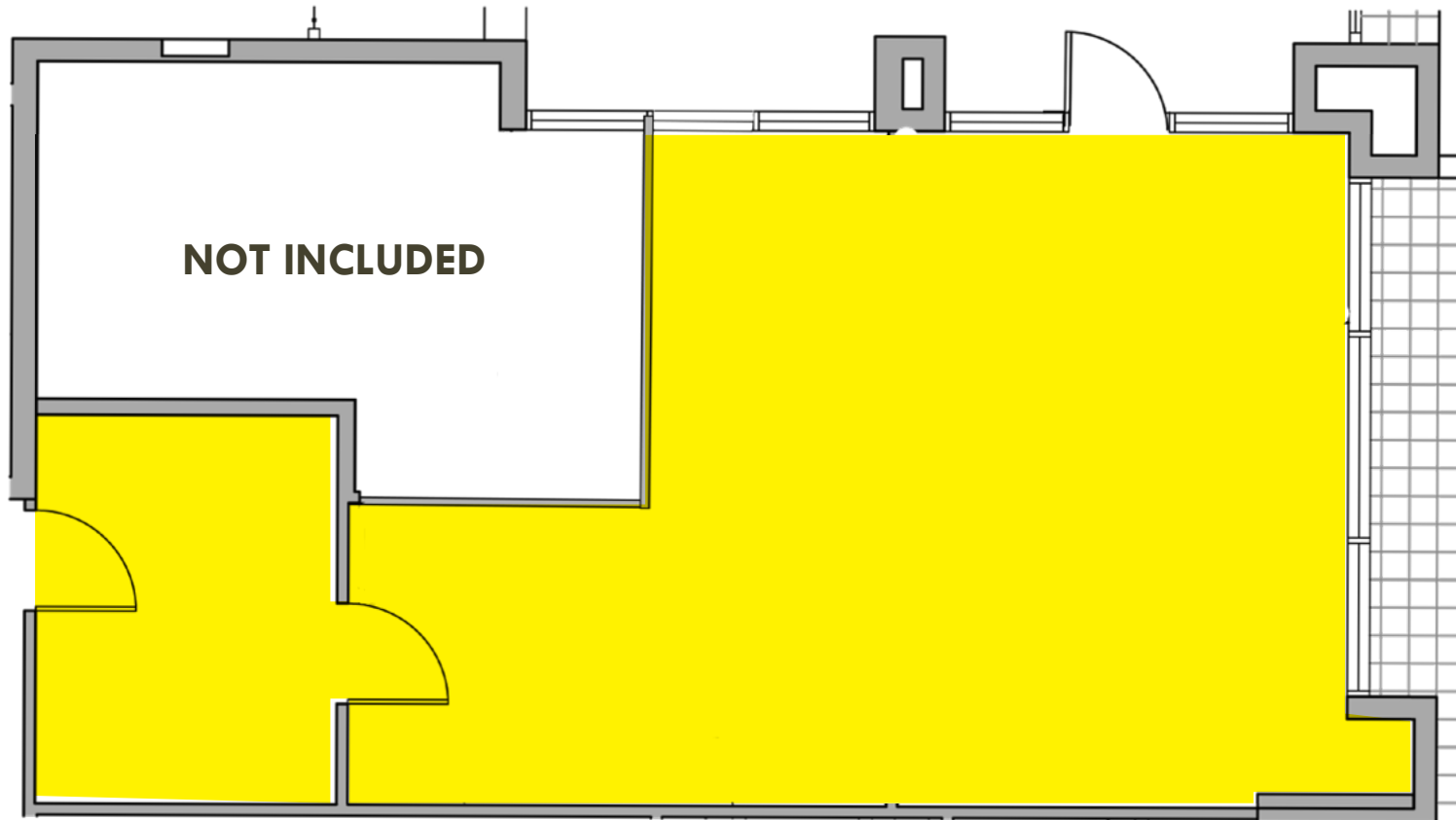

NOT INCLUDED



[www.parccommercial.com](http://www.parcommercial.com)

RAFAEL PADILLA

310.395.2663 X102

RAFAEL@PARCOMMERCIAL.COM

LIC# 00960188

GREG ECKHARDT

310.395.2663 X103

GECKO@PARCOMMERCIAL.COM

LIC#01255469

All information furnished is from sources deemed reliable and which we believe to be correct, but no representation or guarantee is given as to its accuracy and is subject to errors and omissions. All measurements are approximate and have not been verified by Broker. You are advised to conduct an independent investigation to verify all information.



www.parcommercial.com

RAFAEL PADILLA

310.395.2663 X102

RAFAEL@PARCOMMERCIAL.COM

LIC# 00960188

GREG ECKHARDT

310.395.2663 X103

GECKO@PARCOMMERCIAL.COM

LIC#01255469

SANTA M O N I C A

is a world-class shopping, dining and entertainment destination just a stone's throw from the Pacific Ocean. Over 6.5 million visitors a year come from around the globe to visit Santa Monica, named one of National Geographic's top ten beach cities in the world.



www.parcommercial.com

RAFAEL PADILLA

310.395.2663 X102

RAFAEL@PARCOMMERCIAL.COM

LIC# 00960188

GREG ECKHARDT

310.395.2663 X103

GECKO@PARCOMMERCIAL.COM

LIC#01255469

All information furnished is from sources deemed reliable and which we believe to be correct, but no representation or guarantee is given as to its accuracy and is subject to errors and omissions. All measurements are approximate and have not been verified by Broker. You are advised to conduct an independent investigation to verify all information.