

# RETAIL/FLEX SPACE: **FOR LEASE**

**4533-4537 Sepulveda Boulevard, Sherman Oaks, CA 91403**



**SIZE:** Approximately 850-5,300 square feet

**RATE:** \$3.00 per square foot, Modified Gross (Tenant pays utilities and CAM)

**TERM:** 5-10 years

**PARKING:** 3-9 parking spaces on-site free of charge

**AVAILABLE:** Immediately

- Top of building signage
- 50' of window line
- 3 Phase power and HVAC
- Food use ok, but no venting or grease traps
- Major vehicle exposure
- Walking distance to many restaurants, cafes, Whole Foods, and other services
- One block from Sherman Oaks Galleria, World Market and Ventura Boulevard



**JEFF JAROW**  
310.395.2663 x105  
jeff@parcommercial.com  
Lic# 00870996

**RUDY QUINTANAR**  
310.395.2663 x128  
rudy@parcommercial.com  
Lic# 00912513

1250 6th St., #303, Santa Monica, CA 90401 • 310.395.2663 • [www.parcommercial.com](http://www.parcommercial.com)

All information furnished is from sources deemed reliable and which we believe to be correct, but no representation or guarantee is given as to its accuracy and is subject to errors and omissions. All measurements are approximate and have not been verified by Broker. You are advised to conduct an independent investigation to verify all information.

# FLOOR PLAN & MAP

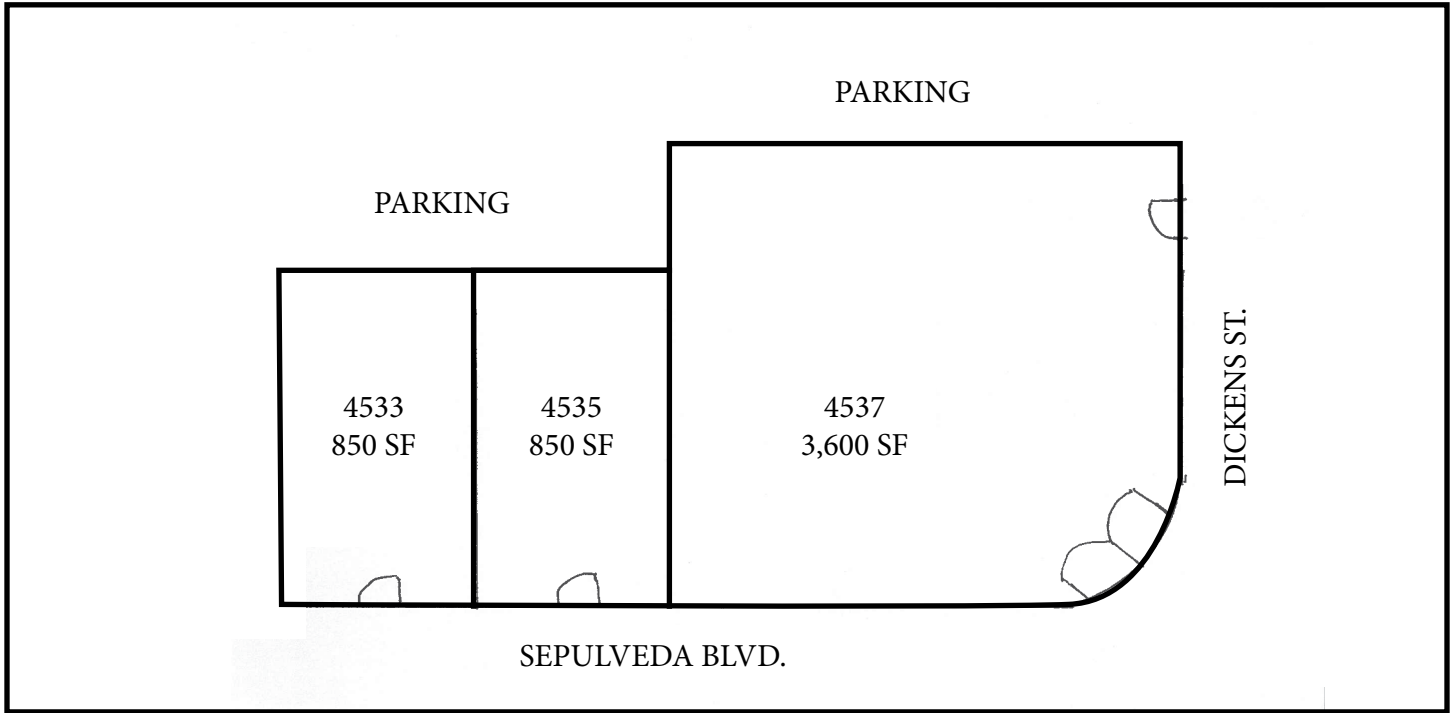

**JEFF JAROW**  
310.395.2663 x105  
jeff@parcommercial.com  
Lic# 00870996

**RUDY QUINTANAR**  
310.395.2663 x128  
rudy@parcommercial.com  
Lic# 00912513

1250 6th St., #303, Santa Monica, CA 90401 • 310.395.2663 • www.parcommercial.com

All information furnished is from sources deemed reliable and which we believe to be correct, but no representation or guarantee is given as to its accuracy and is subject to errors and omissions. All measurements are approximate and have not been verified by Broker. You are advised to conduct an independent investigation to verify all information.