

FOR LEASE

1605 OCEAN FRONT WALK

Santa Monica, CA 90401



FREE STANDING BUILDING FOR THOSE WHO WANT TO MAKE A PRESENCE



RAFAEL PADILLA • 310.395.2663 x102
RAFAEL@PARCOMMERCIAL.COM • LIC# 00960188

JEFF JAROW • 310.395.2663 x105
JEFF@PARCOMMERCIAL.COM • LIC# 00870996

1605 OCEAN FRONT WALK

Santa Monica, CA 90401

If your customers are into **biking, walking, running, surfing** or outdoor activities **then this is your site!**

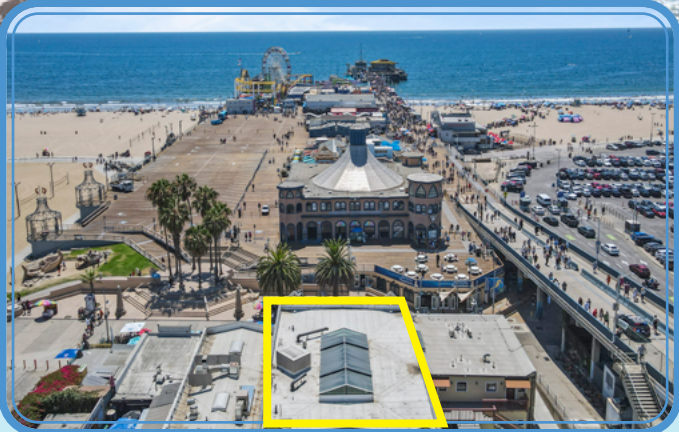
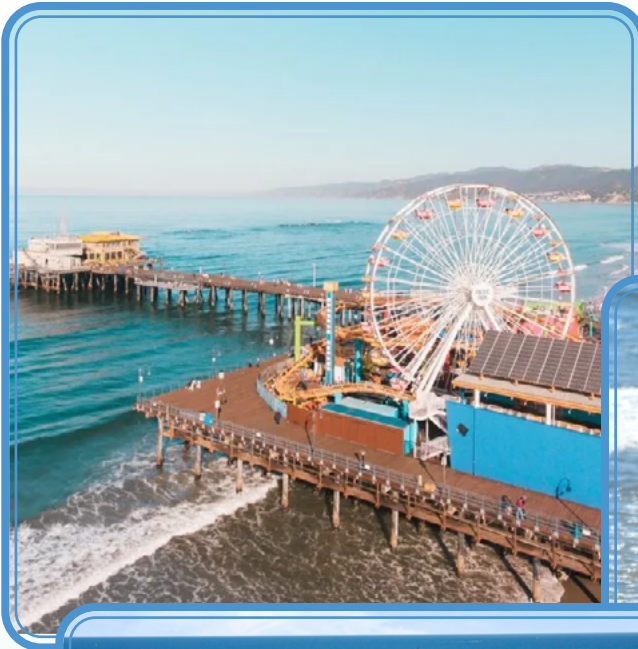

SIZE: Approximately 8,000 square feet, on 2 floors

RATE: \$35,000 per month, Modified Gross
(Tenant pays utilities and janitorial)

PARKING: Adjacent to large public parking lot

AVAILABLE: Immediately

TERM: 5 - 10 years

- Tremendous identity
- High profile location
- Heavy foot traffic
- Great demographics
- Across from Santa Monica Aquarium
- Adjacent to Big Dean's Ocean Front Cafe
- Large front and rear patios
- New construction
- Adjacent to Santa Monica Pier which attracts 8 million visitors per year
- Open air design
- Access from Ocean Front Walk and Appian Way



RAFAEL PADILLA • 310.395.2663 x102
RAFAEL@PARCOMMERCIAL.COM • LIC# 00960188

JEFF JAROW • 310.395.2663 x105
JEFF@PARCOMMERCIAL.COM • LIC# 00870996

All information furnished is from sources deemed reliable and which we believe to be correct, but no representation or guarantee is given as to its accuracy and is subject to errors and omissions. All measurements are approximate and have not been verified by Broker. You are advised to conduct an independent investigation to verify all information.

1605 OCEAN FRONT WALK

Santa Monica, CA 90401



STOREFRONT



GROUND FLOOR



INTERNAL STAIRCASE



SECOND FLOOR



ENTRANCE FROM APPIAN WAY



BOARDWALK VIEW



RAFAEL PADILLA • 310.395.2663 x102
RAFAEL@PARCOMMERCIAL.COM • LIC# 00960188

JEFF JAROW • 310.395.2663 x105
JEFF@PARCOMMERCIAL.COM • LIC# 00870996

All information furnished is from sources deemed reliable and which we believe to be correct, but no representation or guarantee is given as to its accuracy and is subject to errors and omissions. All measurements are approximate and have not been verified by Broker. You are advised to conduct an independent investigation to verify all information.

1605 OCEAN FRONT WALK

SANTA MONICA, CA 90401

8,000 SQUARE FEET OF BEACHSIDE RETAIL

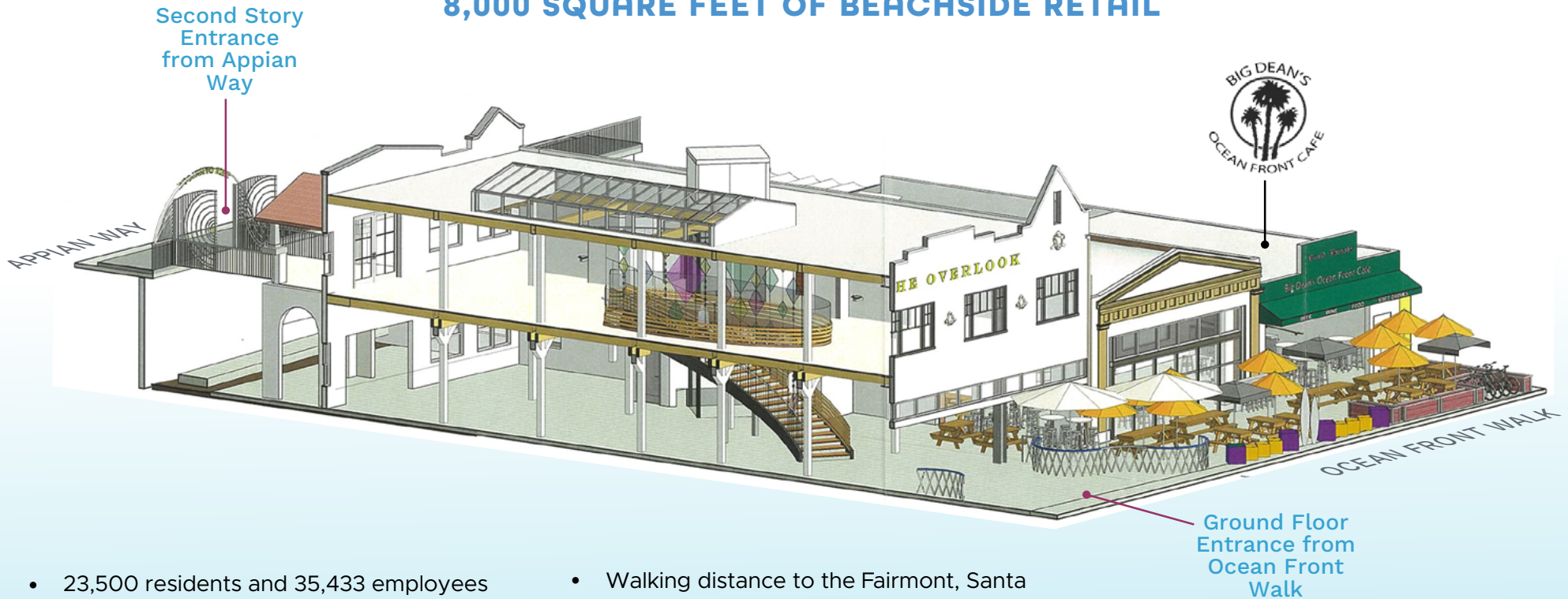

- 23,500 residents and 35,433 employees within one mile of The Overlook
- 696 new residential units under construction in Downtown Santa Monica with 2,074 new units in the pipeline
- 4.02 million square feet of office space
- More than 2,200 city employees nearby
- Walking distance to the Fairmont, Santa Monica Proper Hotel, The Viceroy, Shutters, Loews Hotel, Wyndham, Shore Motel and Hotel Shangri La
- 8 million visitors annually at The Santa Monica Pier
- Three blocks from the Metro E Line with an average of 4 million riders in Q1 2020



RAFAEL PADILLA • 310.395.2663 x102
RAFAEL@PARCOMMERCIAL.COM • LIC# 00960188

JEFF JAROW • 310.395.2663 x105
JEFF@PARCOMMERCIAL.COM • LIC# 00870996

All information furnished is from sources deemed reliable and which we believe to be correct, but no representation or guarantee is given as to its accuracy and is subject to errors and omissions. All measurements are approximate and have not been verified by Broker. You are advised to conduct an independent investigation to verify all information.

1605 OCEAN FRONT WALK

Santa Monica, CA 90401

FIRST FLOOR RETAIL

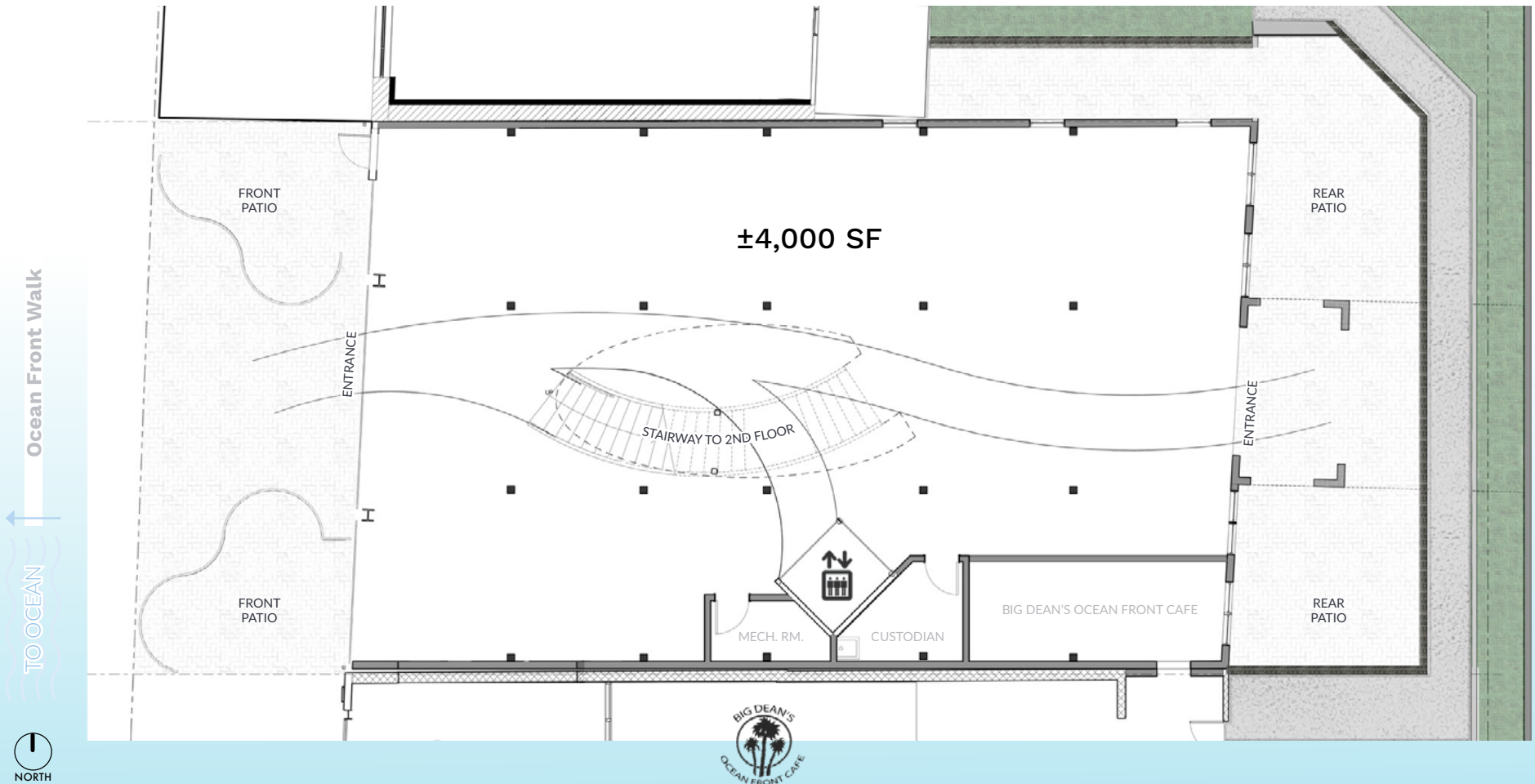

RAFAEL PADILLA • 310.395.2663 x102
RAFAEL@PARCOMMERCIAL.COM • LIC# 00960188

JEFF JAROW • 310.395.2663 x105
JEFF@PARCOMMERCIAL.COM • LIC# 00870996

All information furnished is from sources deemed reliable and which we believe to be correct, but no representation or guarantee is given as to its accuracy and is subject to errors and omissions. All measurements are approximate and have not been verified by Broker. You are advised to conduct an independent investigation to verify all information.

1605 OCEAN FRONT WALK

SANTA MONICA, CA 90401

SECOND FLOOR RETAIL

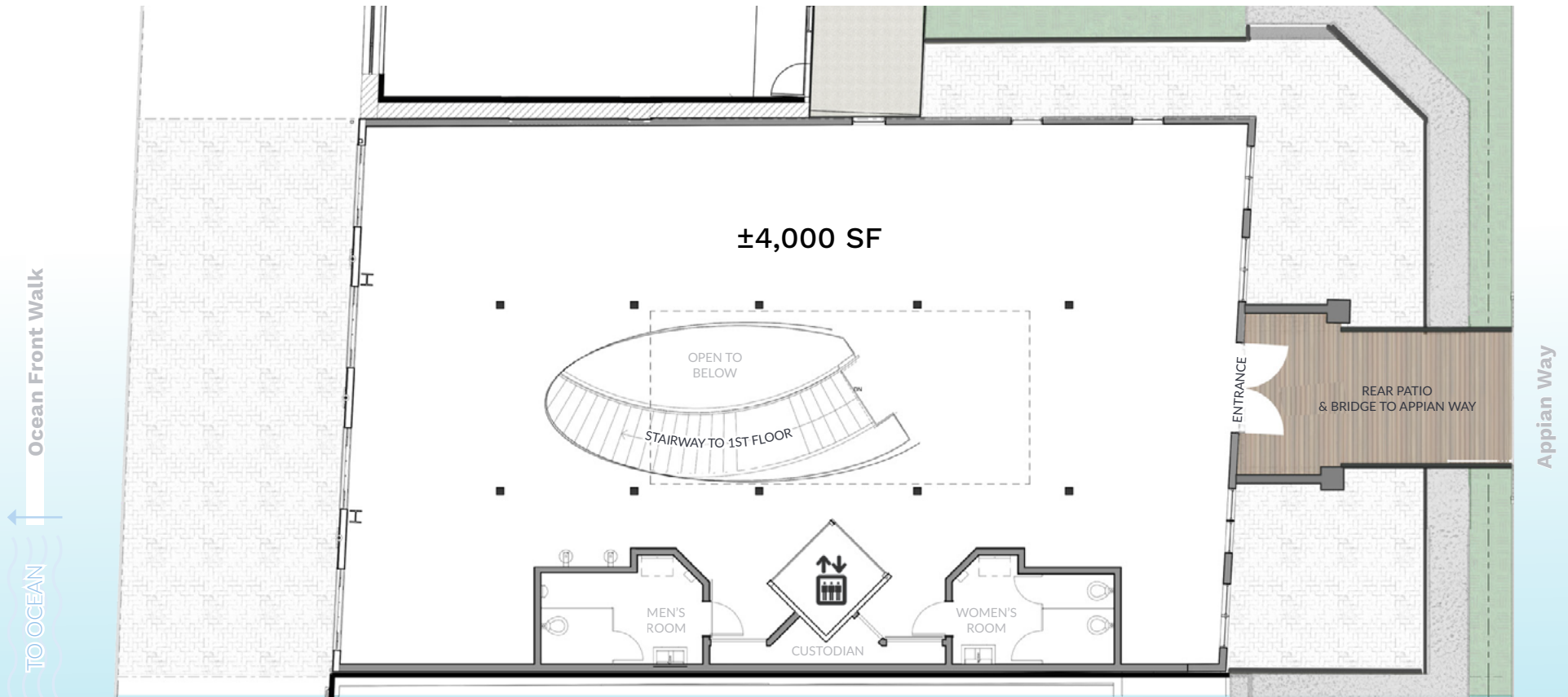

Ocean Front Walk

TO OCEAN

Appian Way



NORTH



PAR
COMMERCIAL BROKERAGE

RAFAEL PADILLA • 310.395.2663 x102
RAFAEL@PARCOMMERCIAL.COM • LIC# 00960188

JEFF JAROW • 310.395.2663 x105
JEFF@PARCOMMERCIAL.COM • LIC# 00870996

All information furnished is from sources deemed reliable and which we believe to be correct, but no representation or guarantee is given as to its accuracy and is subject to errors and omissions. All measurements are approximate and have not been verified by Broker. You are advised to conduct an independent investigation to verify all information.

1605 OCEAN FRONT WALK

Santa Monica, CA 90401

AREA MAP

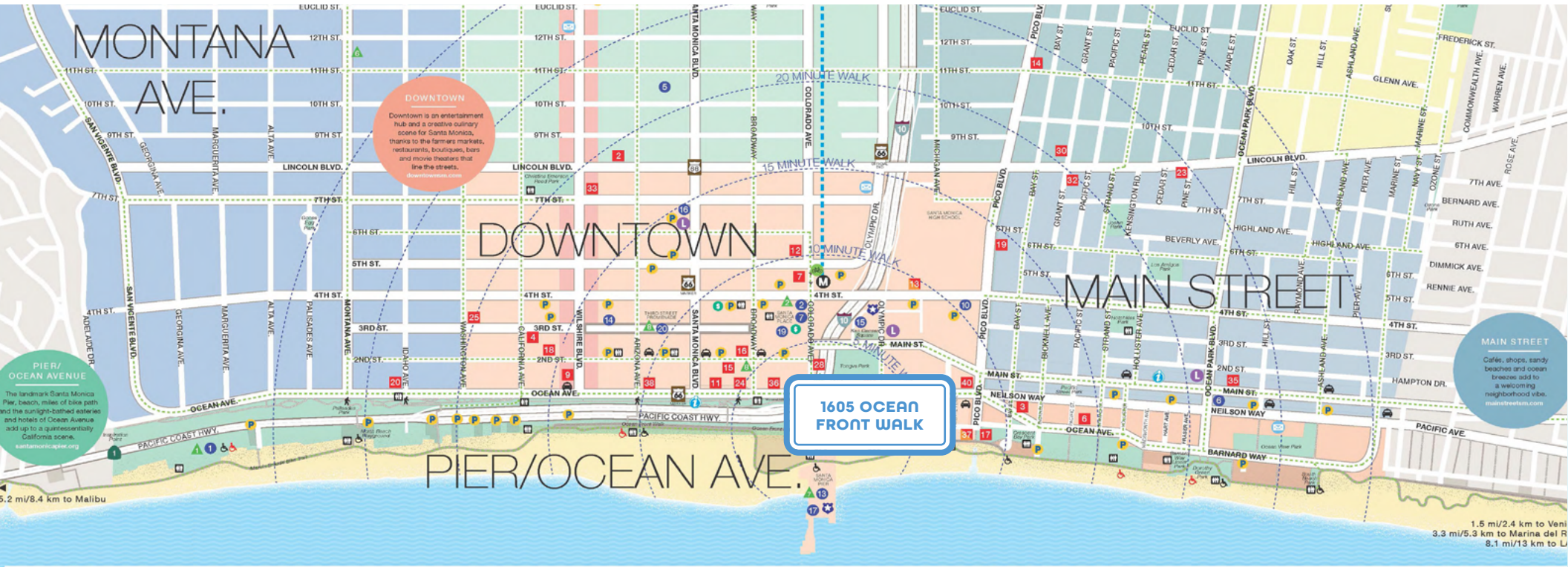

HOTELS

- | | | | |
|--|---|---|--|
| 1 The Ambrose Hotel GB | 11 The Georgian Hotel O9 | 21 Ocean Lodge Hotel Santa Monica Beach O11 | 31 Sandbourne Santa Monica P12 |
| 2 American Motel LB | 12 Hampton Inn & Suites Santa Monica M11 | 22 Ocean Park Hotel C17 | 32 Santa Monica Hotel L14 |
| 3 Bayside Hotel P13 | 13 Hilton Santa Monica Hotel & Suites N12 | 23 Ocean Park Inn L15 | 33 Santa Monica Proper Hotel LB |
| 4 Cal Mar Hotel Suites O7 | 14 Holiday Motel K13 | 24 Ocean View Hotel O10 | 34 Sea Blue Hotel O11 |
| 5 Comfort Inn Santa Monica-West Los Angeles D9 | 15 Hostelling International LA/Santa Monica O10 | 25 Palhouse Santa Monica N6 | 35 Sea Shore Motel O16 |
| 6 The Cottage Santa Monica P14 | 16 Hotel Carmel O10 | 26 Palm Motel J14 | 36 Shore Hotel O10 |
| 7 Courtyard by Marriott Santa Monica N11 | 17 Hotel Casa del Mar P13 | 27 Pavilions Motel F17 | 37 Shutters on the Beach P13 |
| 8 Days Inn by Wyndham Santa Monica C9 | 18 The Huntley Hotel Santa Monica Beach O7 | 28 The Pierside Santa Monica O11 | 38 Sonder The Beacon O9 |
| 9 Fairmont Miramar Hotel & Bungalows O8 | 19 Le Méridien Delina Santa Monica M13 | 29 Regent Santa Monica Beach O12 | 39 SureStay by Best Western Santa Monica C15 |
| 10 Gateway Hotel Santa Monica G10 | 20 Oceana Santa Monica O6 | 30 Rest Haven Motel L14 | 40 Viceroy Santa Monica O13 |

ATTRACTIONS

- | | |
|--------------------------------------|-----------------------------------|
| 1 Annenberg Community Beach House P3 | 13 Pacific Park P11 |
| 2 Arte Museum Opening 2025 N11 | 14 Santa Monica Art Museum N8 |
| 3 Barker Hangar D20 | 15 Santa Monica City Hall N11 |
| 4 Bergamot Station Arts Center D12 | 16 Santa Monica History Museum M9 |
| 5 BroadStage K9 | 17 Santa Monica Pier O11 |
| 6 California Heritage Museum O16 | 18 Santa Monica Pier Carousel P11 |
| 7 Cayton Children's Museum N11 | 19 Santa Monica Place N10 |
| 8 18th Street Arts Center H11 | 20 Third Street Promenade N9 |
| 9 Heal the Bay Aquarium P11 | |
| 10 Historic Belmar Park N13 | |
| 11 Museum of Flying C20 | |
| 12 Original Muscle Beach P11 | |



RAFAEL PADILLA • 310.395.2663 x102
 RAFAEL@PARCOMMERCIAL.COM • LIC# 00960188

JEFF JAROW • 310.395.2663 x105
 JEFF@PARCOMMERCIAL.COM • LIC# 00870996

All information furnished is from sources deemed reliable and which we believe to be correct, but no representation or guarantee is given as to its accuracy and is subject to errors and omissions. All measurements are approximate and have not been verified by Broker. You are advised to conduct an independent investigation to verify all information.